

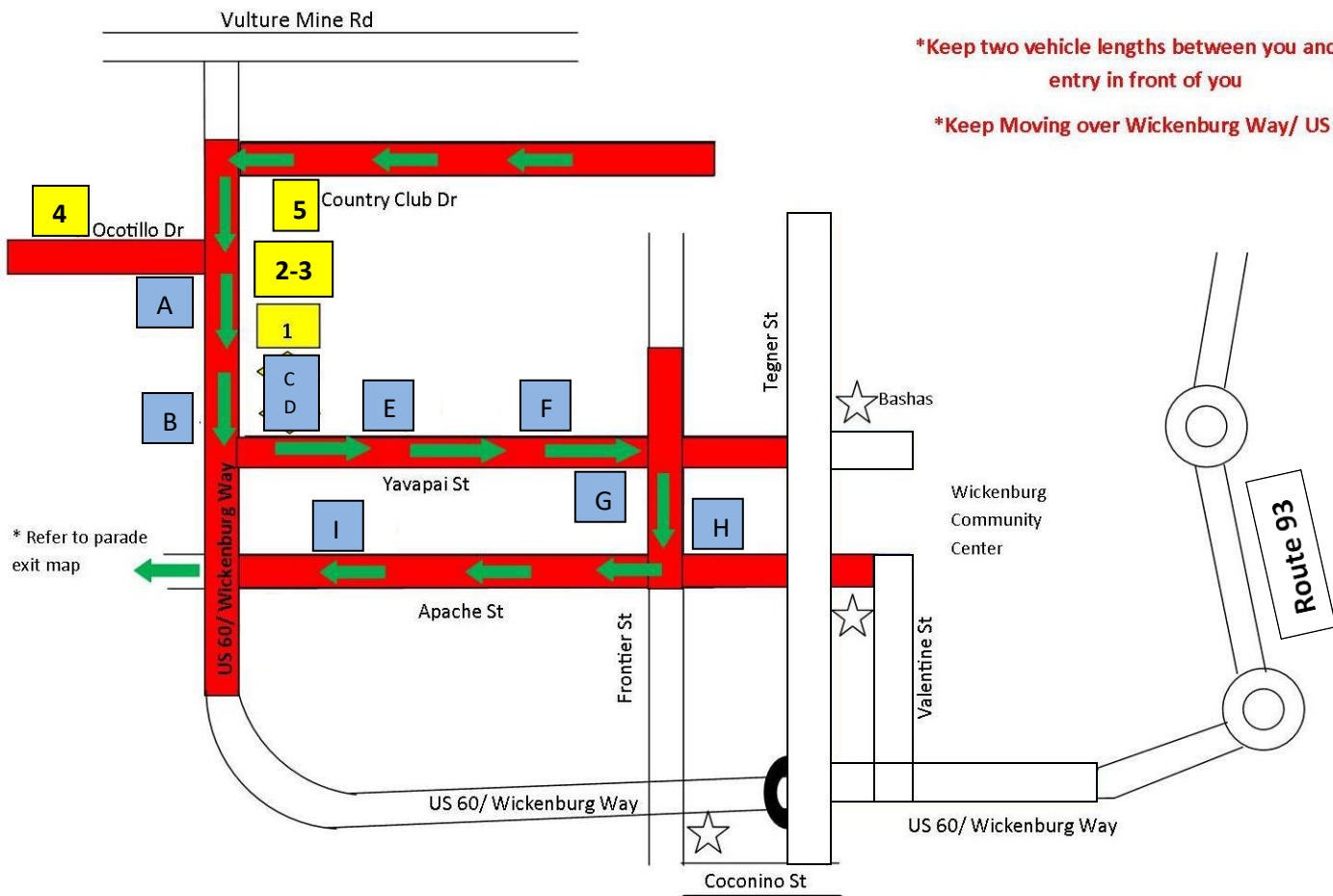

72nd Annual Gold Rush Days Parade Route



*Keep two vehicle lengths between you and the entry in front of you
 *Keep Moving over Wickenburg Way/ US 60

- Road Closed 8:30am- 11:30am
- Parade Route
- Public Parking: FEE
- Overpass

1. **REGISTRATION** - RANDY'S AUTOMOTIVE
2. **HONORY DIVISION**- SUNSHINE PLAZA
3. **BANDS**- WICKENBURG VETERINARY (ACROSS THE STREET FROM REGISTRATION)
4. **DIVISION 1**- OCOTILLO DR. AND W. WICKENBURG WAY
5. **DIVISION 2 & 3**- COUNTRY CLUB DR. AND W. WICKENBURG WAY
- A. **1ST ANNOUNCERS STAND**-IN FRONT OF NATIONAL ROPER SUPPLY
- B. **2ND ANNOUNCER'S STAND**- QUICKLANE PARKING LOT
- C. **3RD ANNOUNCER'S STAND**- NATIONAL BANK
- D. **4TH ANNOUNCER'S STAND**- DOUBLE J COURT SELF STORAGE
- E. **5TH ANNOUNCER'S STAND**- WICKENBURG CHRISTIAN ACADEMY
- F. **6TH ANNOUNCER'S STAND**- WICKENBURG UNIFIED SCHOOL DISTRICT
- G. **7TH ANNOUNCER'S STAND AND JUDGES STAND**-WICKENBURG CHAMBER OF COMMERCE
- H. **8TH ANNOUNCER'S STAND**- HASSAYAMPA BUILDING
- I. **9TH ANNOUNCER'S STAND**- POTTERS HOUSE

* Refer to parade exit map

* map not to scale





72nd Annual Gold Rush Days Parade Route



NO
THROWING
CANDY !!



RETURN
ROUTE

*Map is not drawn to scale, please refer to directions at right

Do Not Stop On
Apache St.
Continue on Exit
Route

CONTINUE ON APACHE ST. OVER WICKENBURG WAY
LEFT ONTO KELLIS RD.
RIGHT ONTO AMERICA ST.
LEFT ONTO W. PALO VERDE DR.
RIGHT ONTO SUNNY COVE HIEGHTS RD.
RIGHT ONTO MARIPOSA DR.
LEFT ONTO AMERICA ST.
RIGHT ONTO W. WICKENBURG WAY

PLEASE DO NOT LEAVE YOUR LINE-UP AREA LITTERED. PICK UP TRASH AND **WATCH FOR VEGETATION AND LANDSCAPED AREAS.**

YOU MAY PARK ON KELLIS RD., CENTER STREET, LINCOLN, N. & S. OXBOW OR ANY OF THE SURROUNDING STREETS FOR PICK UP AFTER THE PARADE.

Thank you for participating in our 72nd Annual Gold Rush Days Parade!
See ya'll next year!!

Parade Contact:
Wickenburg Chamber
928-684-5479
events@wickenburgchamber.com